

Thank you for purchasing the MEIKEE solar light. In order to use this product safely, please read this manual before use. If you have any questions about this product, please contact our customer service as soon as possible. Our after-sales team will contact you at first time and solve any problems related to the product.

E-mail: meikee@meikeelighting.com

Attention

1. Because the solar panel is charged during the day, it will not turn on during the day. If you want to test the light during the day, please cover the solar panel or go to a dark room to test. (Do not shine the light on the solar panel in a dark environment, otherwise the light will flicker with high frequency)
2. The working time of the lamp is related to the charging time. The charging effect in a sunny day will be better than that in a rainy day. In the case of continuous rainy days, the light may not be turned on because it is not charged. Please charge 8H when the sunlight is sufficient, the lamp will turn on again.
3. Please install the solar panel in a place with sufficient sunlight. Note that places like tree shade or grass will affect the charging effect.
4. When you receive the product for the first time, please fully charge it before using it (at least 8 hours or more) to ensure the duration of the light.
5. Please clean the solar panel regularly to ensure the charging effect.
6. Do not disassemble and modify the product by yourself to avoid product damage.
7. Please stay away from fire sources. The waterproof rating of this product is IP66. Do not use it in water.

Product name

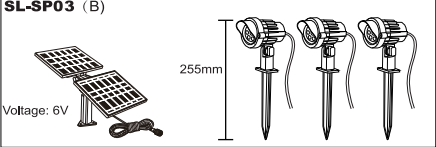
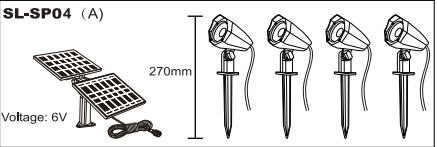

Parameter table

Model	Solar Panel	18650Battery capacity	Working Voltage	Color temperature			Lighting angle/Projection distance						Charging time	Full working hours		Waterproof Rating	Extention cord	Control method	Lamp body material	Ta
							A		B		C			High brightness	Low brightness					
SL-SP04	6V/4W	1500MAH*3	3V/DC	2700K	4000K	6000K	25°	5M	25°	5M	120°	3M	8H	About6H	About12H	IP66	5m	Light Control	Aluminum/PC	-25℃~40℃
SL-SP03	6V/4W	1500MAH*3	3V/DC	2700K	4000K	6000K	25°	5M	15°	5M	120°	3M	8H	About6H	About12H	IP66	5m	Light Control	Aluminum/PC	-25℃~40℃
SL-FL03	6V/4W	1500MAH*3	3V/DC	2700K	4000K	6000K	/	/	25°	5M	120°	3M	8H	About6H	About12H	IP66	5m	Light Control	Aluminum/PC	-25℃~40℃
SL-FL05	6V/4W	1500MAH*3	3V/DC	2700K	4000K	6000K	/	/	15°	5M	120°	3M	8H	About6H	About12H	IP66	5m	Light Control	Aluminum/PC	-25℃~40℃

Installation Steps

**Step 1:** Punch three holes on the mounting wall according to the holes of the fixing bar.

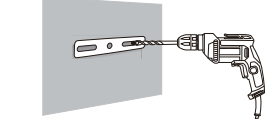

**Step 2:** Link the fixing bar to the junction box with two long screws.

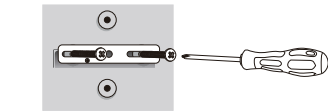

**Step 3:** Remove the protective paper partition from the adhesive surface of the EVA seal, pull out the power cord through the opening of the EVA seal, and stick the EVA seal to the base of the lamp.

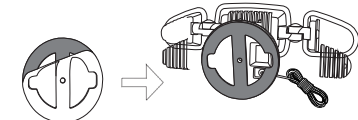

**Step 4:** Use a long screw to pass through the hole in the center of the lamp connect to the center hole of the fixing bar.

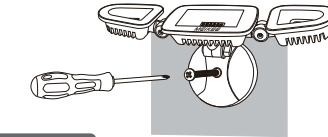

How to Work

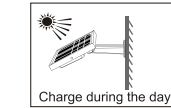

Light and solar panel extension cord connections

Method 1: Connect the male and female ends of the extension cord and tighten the waterproof cap.

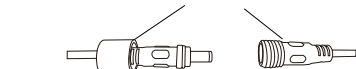

Method 2: Junction box wiring method

(1) Use a screwdriver to remove the screws from the bottom cover of the junction box and open it.

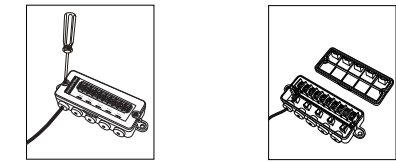

(2) Thread the end of the lamp extension cord into the junction box.

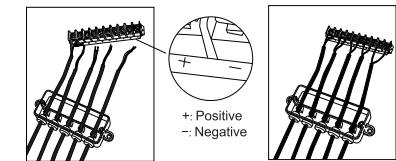

(3) Use a screwdriver to tighten the screws on the wires and terminals and place the wires in the slots.

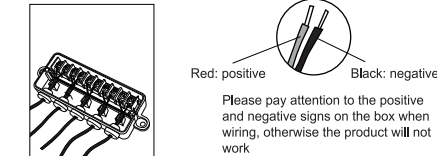

(4) Tighten the bottom cover of the junction box with screws.

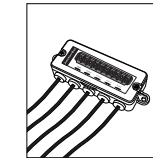

Battery replacement

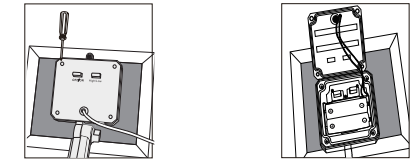

1. Use a screwdriver to remove the screws of the battery box. 2. Open the battery box.

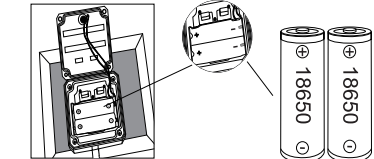

3. Remove the old battery and install a new battery.

**⚠ Note:** 1. The capacity of the replacement battery should be greater than or equal to the original battery, otherwise it will affect the light lighting time. 2. The positive and negative terminals of the battery should be installed correctly to avoid damaging the battery and the lamp.

FAQ

**Q: The lamp doesn't work.**

A: 1. Make sure the lamp is switch on.

A: 2. The battery is out of power and charge the battery by solar panel in direct sunlight.

**Q: Lighting time is short.**

A: 1. The working time depends on the power which stores in the rechargeable battery. (The battery can only be fully charged in a sunny environment)

A: 2. The more power it charges during the day, the longer time it works during the night.

**Q: Charging time.**

A: 1. Charging for over 8 hours is recommended. The solar products' charging time is affected by weather condition and installation location.

Introduction of battery box

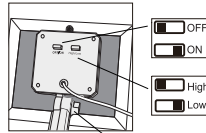

**OFF/ON:** turn off/on the solar panel and spotlight

**High/ Low:** Set the brightness to high/low. After being fully charged, when set to High, the lighting time is about 6H, when set to Low, the lighting time is about 12 hours.

90 degrees adjustable angle

Solar panel installation



Ground-mounted

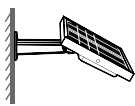

Wall mounted

Note: The solar panel needs to be installed in a place where there is sufficient sunlight. Note that places like tree shade or grass will affect the charging effect.

Spotlight installation



Ground-mounted

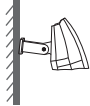

Wall mounted

Flood light installation

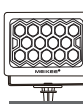

Ground-mounted

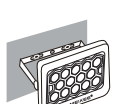

Wall mounted



Company name: Shenzhen Oumeike Lighting Technology Co., Ltd.

Address: No. 19-20, Anye Road, Yuanshan Street, Longgang District, Shenzhen, Guangdong, China (+86 0755-28608199)

C&E Connection E-Commerce (DE) GmbH  
Zum Linnegraben 20, 65933, Frankfurt am Main, Germany  
E-mail: info@ce-connection.de Tel: +49 (069) 27246648

http://www.meikeelighting.com  
E-mail: meikee@meikeelighting.com